

ORDINANCE NO. 14-16
AN ORDINANCE AMENDING RESOLUTIONS 30-81 AND 35-92
CHANGING THE SPEED LIMIT ON BELFAIR TAHUYA ROAD
IN MASON COUNTY

WHEREAS, the Revised Code of Washington (RCW) 46.61.415 permits local authorities to establish or alter maximum legal speed limits pursuant to RCW 46.61.400 on County road on the basis of an engineering and traffic investigation finding that the maximum speed is greater or less than reasonably safe, and

WHEREAS, in accordance with Chapter 10.04 of the Mason County Code the board of county commissioners, by ordinance, may raise or lower a speed limit on any county road, except raising above fifty miles per hour.

WHEREAS, Mason County previously established, along with numerous other county roads, an alternate speed limit for the Belfair Tahuya Road on April 20, 1981 under Resolution 30-81 and again on March 17, 1992 under Resolution 35-92.

WHEREAS, the County Engineer has reviewed the engineering traffic investigation and recommendation and has determined a portion of Belfair Tahuya Road warrants a speed limit change, with the entire road posting showing as follows:

<u>ROAD NO.</u>	<u>ROAD NAME</u>	<u>SPEED</u>	<u>M.P. - M.P.</u>
97500	Belfair Tahuya Road	35	0.000 - 0.133
	Belfair Tahuya Road	45	0.133 - 11.749

THEREFORE, BE IT RESOLVED, that this ordinance amends those portions of Resolutions 30-81 and 35-92 pertaining to Belfair Tahuya Road;

THEREFORE, BE IT RESOLVED AND ORDERED, that the speed limit is effective immediately as shown for Belfair Tahuya Road and the County Engineer is so directed to erect the necessary speed limit signs in conformity herewith.

DATED this 16 of Feb, 2016.

**BOARD OF COUNTY COMMISSIONERS
MASON COUNTY, WASHINGTON**

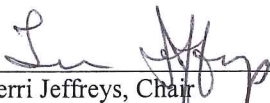
Terri Jeffreys, Chair

Absent
Tim Sheldon, Vice Chair

Randy Neatherlin, Commissioner

ATTEST:

Julie Almanzor, Clerk of the Board

APPROVED AS TO FORM:

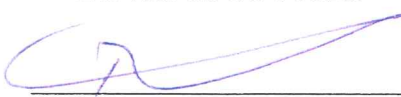
Tim Whitehead,
Deputy Prosecuting Attorney



MASON COUNTY
DEPARTMENT of PUBLIC WORKS
100 W PUBLIC WORKS DRIVE
SHELTON, WASHINGTON 98584

MEMORANDUM –Exhibit 1

TO: Melissa McFadden, PE
Deputy Director/County Engineer

FROM: Dave Smith, PE, Transportation Engineer
Loretta Swanson, Technical Services Manager

DATE: January 6, 2016

**SUBJECT: Proposed Speed Limit Change –Belfair Tahuya Road
Engineer's Report and Recommendations**

Mason County Public Works periodically reviews speed limits on county roads for consistence and applicability. There are presently two different speed limits for the same section of Belfair Tahuya Road depending on which direction motorists are travelling. North bound traffic is 45 MPH and south bound traffic 35 MPH, making it difficult to enforce and potentially confusing to the travelling public. In an effort to aid speed limit enforcement by the Sheriff's Department and reduce potential confusion, it is recommended to reduce the speed limit on Belfair Tahuya Road for north bound traffic, just north of the intersection of North Shore Road, for the first 700 feet.

Based on a review and analysis of traffic conditions at this location, the following is recommended:

RECOMMENDATION

The speed limit on Belfair Tahuya Road should be 35 MPH from MP 0.00 to 0.133.

Belfair Tahuya Road Vicinity Map

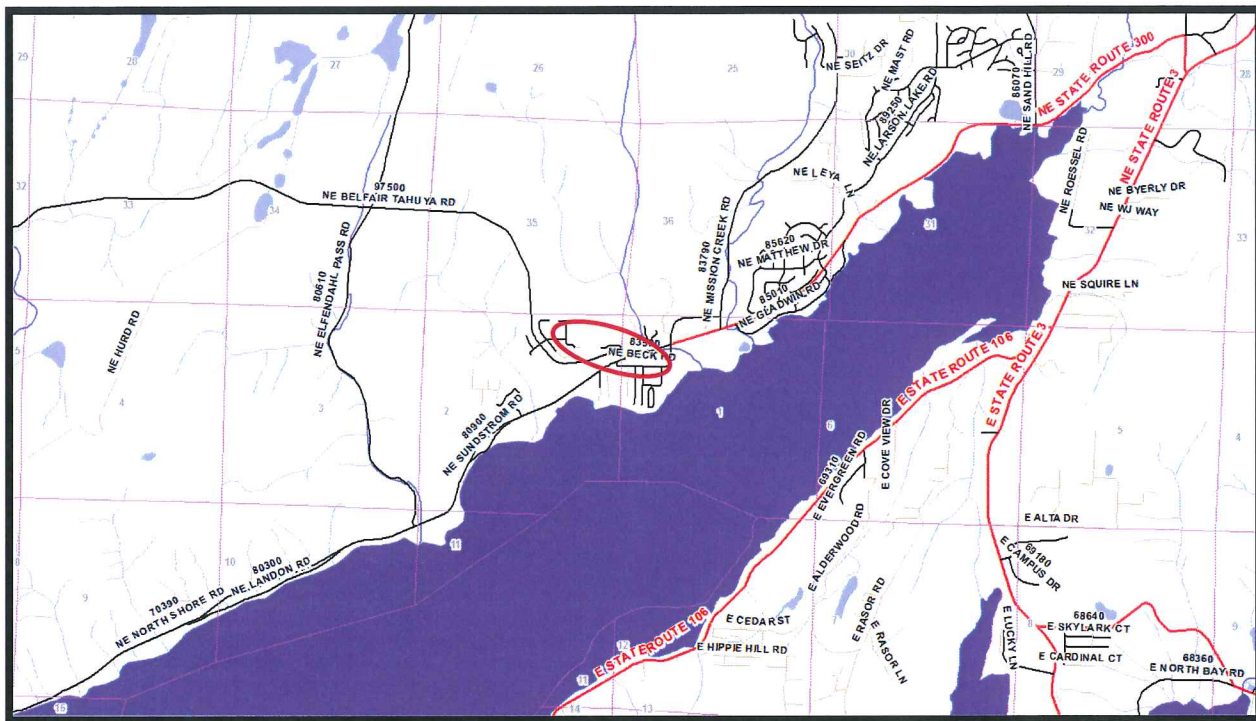

Proposed Speed Limit 35 MPH from MP 0.00 to MP 0.133

